



3 Beds + Pocket Office



2 Baths



1,720 SQ FT



2 Car Garage

The Fraser floor plan showcases a thoughtfully designed single-story arrangement, boasting a spacious living room with vaulted ceilings and an exquisitely crafted kitchen. The Fraser is ideal for families, couples or anyone seeking a value-packed home with an extra touch of style:

- **Escape the hustle and bustle of daily life** at the core of the home by retreating to the private cluster of conveniently-located bedrooms.
- **Enjoy an additional retreat** in your tranquil primary suite that includes a walk-in closet and private ensuite bathroom.
- **The kitchen, dining, and living areas extending from the entry to the back** provide extra privacy and an open layout filled with natural light.
- **A wonderfully placed pocket office** right at the front of the house creates a flexible space that you can use for work, play, pets, or more.

The Fraser is a charming home that beautifully balances aesthetics with the everyday needs of a modern family, creating a perfect haven for your loved ones.

Top Features

- Energy Star Certified
- Full A/C
- ERV (Energy Recovery Ventilator)
- Vaulted Ceilings
- Covered Front Porch
- 8' Front Door
- Luxury Laminate Plank in Main Living Areas
- Premium Vinyl Windows
- Keyless Front Entry
- Video Doorbell



ARCHITERRA

myarchiterra.com

The Fraser

Main Floor



Elevations



Structural Options

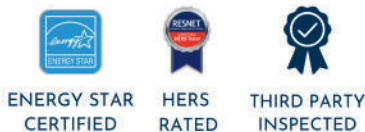
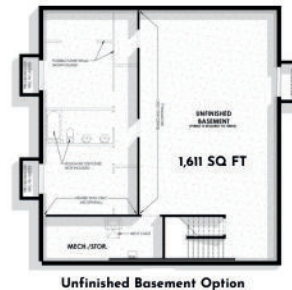
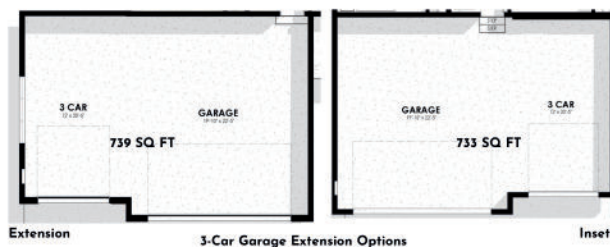
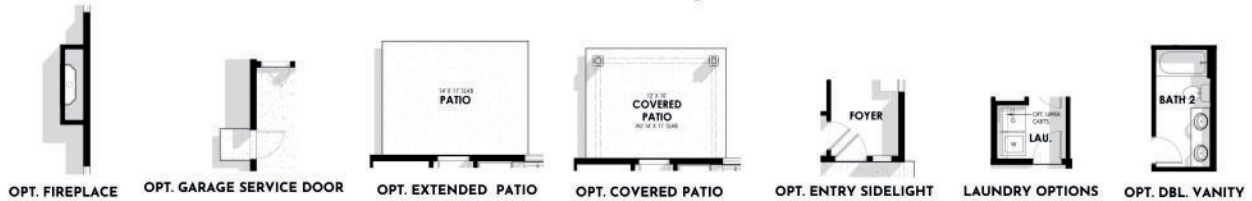

Renderings and floor plans are for representational purposes only and may not reflect the exact features or dimensions of your home. All dimensions are subject to field variations. Some design features and options shown may vary by community. All options to be included in your home must be specified in an exhibit to the agreement of sale. Archterra Homes, LLC, reserves the right to modify, amend, or change the representational rendering and plan at any time without notice. Please consult our sales representatives for more information at (208) 449-1905 or visit www.myarchterra.com
Revised 11/1/2023

